



## Capacitive Sensors Series Leak

### Housing Ø 38 mm

- Leakage control in clean room / Alarm for containers and pipelines. Mounting in „drip trays“ of plastic, glass or metal
- Housing material: PTFE
- Flush mountable
- Semiconductor Industry, Chemical Industry

Certificate:



#### Technical data

Operating distance Sn [mm], flush mounting	2, yes
Operating distance min./max. [mm] adjustable	-
Electrical version	3-wire DC
Output	NO
Type NPN	Leak-500-N-S-PTFE
Art.-No.	KA 0387
Connection diagram No.	1

Type PNP	Leak-500-P-S-PTFE
Art.-No.	KA 0388
Connection diagram No.	4
Operating voltage ( $U_B$ )	10...35 V DC
Output current max. ( $I_e$ )	250 mA
Load current min.	-
Voltage drop max. ( $U_d$ )	< 2,0 V
Permitted residual ripple max.	10%
No-load current ( $I_o$ )	typ. 15 mA
Frequency of operating cycles max.	-
Permitted ambient temperature	Clean room conditions
LED-display	green/red
Protective circuit	built-in
Degree of protection IEC 529	IP 67
Connection cable	2, screened, 3 x 0,14 mm
Housing material	PTFE
Active surface	PTFE
Lid	PTFE

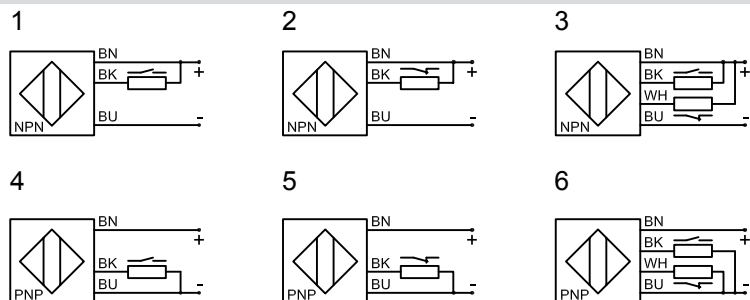
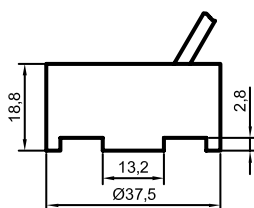

All specifications are subject to change without notice. (29.09.2006)